

USER MANUAL

Lex
rotary

strymon®

Front Panel

.....

FAST ROTOR SPEED: Controls the speed of the rotors in FAST speed.

MIC DISTANCE: Varies the distance of the stereo mics from the horn rotor and the single mic on the woofer rotor. Turn towards minimum for a more pronounced, aggressive horn sound with mics up close. Turn towards maximum for more ambience. The effect will be most audible with the horn rotor.

PREAMP DRIVE: Controls the drive of the rotary cabinet's tube preamp and phase inverter stages. Turn up for a more overdriven cab sound.



HORN LEVEL: Controls the output level of the high frequency horn rotor.

SLOW / FAST FOOTSWITCH: Changes the motor speed from fast to slow. **HOLD** for brake.

BYPASS FOOTSWITCH: Engages and disengages effect. Bypass mode is **true bypass**. LED on indicates that the effect is engaged.

Secondary Functions

CAB DIRECTION: Changes the position of the cabinet relative to the microphones. In the FRONT orientation (counterclockwise) the sound travels through the slats in the wood cabinet. In the REAR orientation (clockwise), the the cabinet is open for a different sound. The default position is REAR.

ACCELERATION: Controls how quickly the rotors transition from Fast to Slow and from Slow to Fast speed. The rotors will accelerate independently. The low frequency rotor accelerates more slowly just like an actual rotating speaker system.

SLOW ROTOR SPEED: Controls the speed of the rotors in SLOW speed.

LEVEL: Controls the +/- 6dB boost or cut when the pedal is engaged (12:00 on the PREAMP DRIVE (LEVEL) knob is unity gain)



Hold down **SLOW/FAST** and **BYPASS** to access all **secondary functions** on the knobs.

Rear Panel

.....

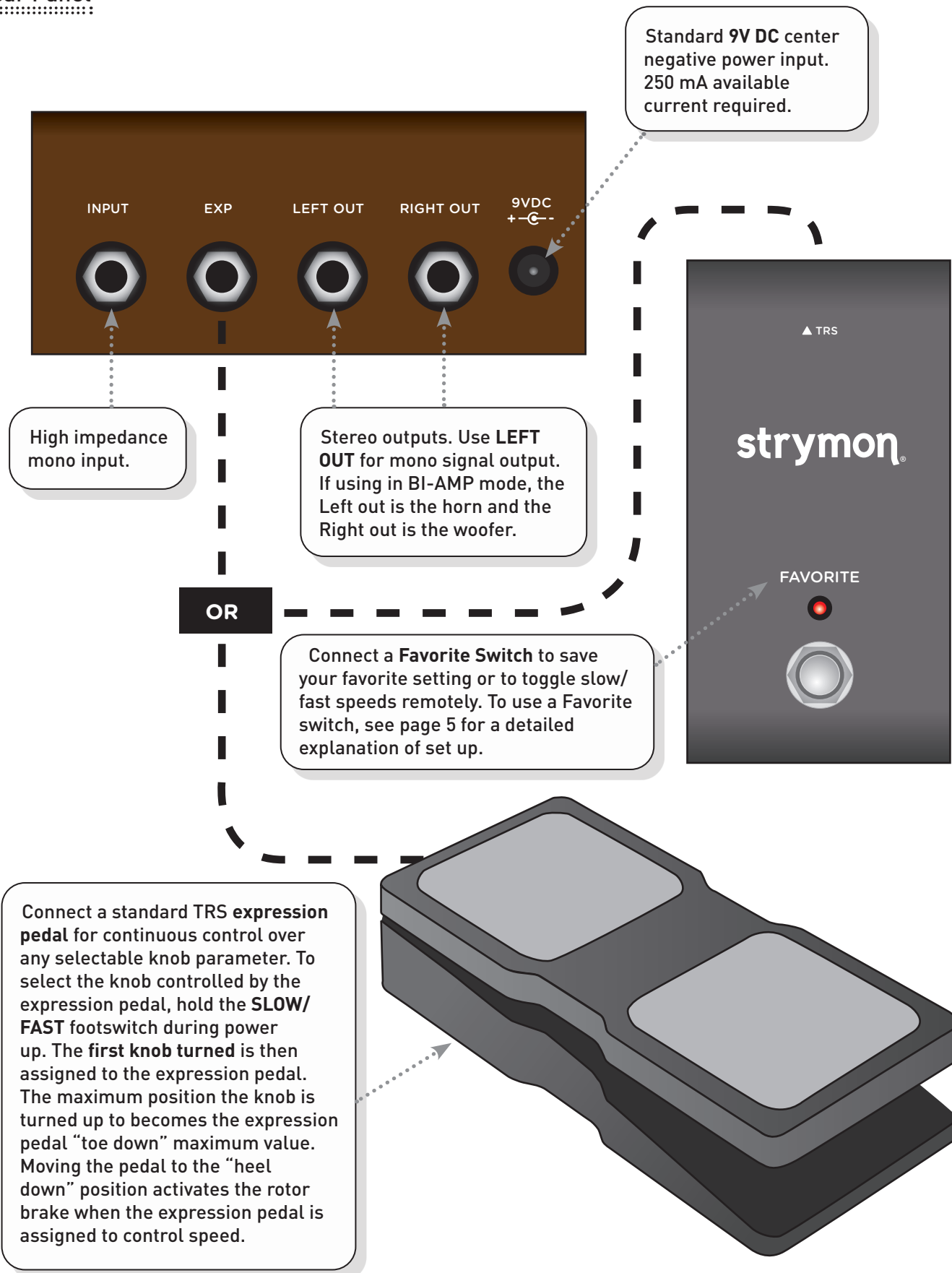

Power up settings

EXP INPUT ASSIGN: Assigns the EXP pedal input jack to use an expression pedal or a Favorite switch. While holding both footswitches at power up, turn FAST ROTOR SPEED fully counterclockwise for use with an expression pedal. Turn knob fully clockwise for use with a Favorite Switch to save a favorite setting. Turn knob to the middle position to use a Favorite switch to toggle between FAST and SLOW rotor speeds.

CAB FILTER: Tailors the cabinet filter for best use either in front of a guitar amplifier or a full range speaker system. While holding both footswitches at power up, turn MIC DISTANCE fully counterclockwise for use with a GUITAR AMP. Turn MIC DISTANCE fully clockwise for use with a FULL RANGE speaker system, e.g. studio monitors. Full range mode is also useful for direct recording.

BI-AMP: While holding both footswitches at power up, turn PREAMP DRIVE fully clockwise for Bi-Amp ON. When in BIAMP mode, the Left output is the horn signal and the Right output is the woofer signal. For Bi-Amp OFF (stereo mode), turn PREAMP DRIVE fully counterclockwise.



When a knob is adjusted, LEDs will light up to indicate which selection has been made for each start up setting. For a counterclockwise setting the SLOW/FAST LED will light. For a clockwise setting the BYPASS LED will light. For a mid knob setting both LEDs will light.

HOLD BOTH AT POWER UP

Factory settings

.....

Secondary functions: Cab direction set to REAR. All other secondary functions set to 50%

EXP input jack: Assigned to use an expression pedal and vary the SPEED from BRAKE to FAST

BI-AMP MODE: OFF

EXP INPUT ASSIGN: Assigned to use an expression pedal

CAB FILTER: Assigned to GUITAR AMP mode

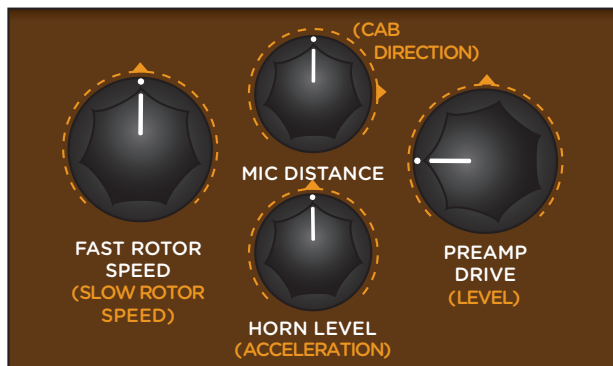

Sample Settings



Mellowed Out

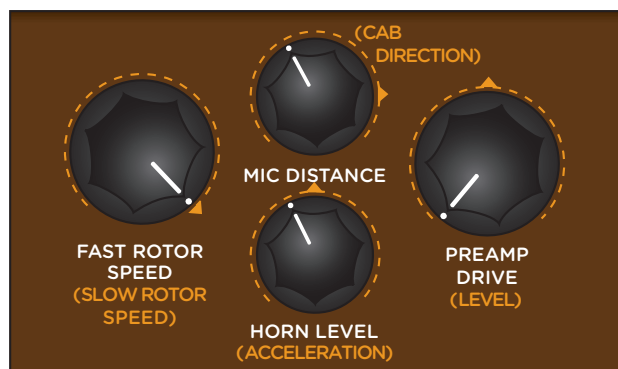

Rotary Brake



Fat Harmonics

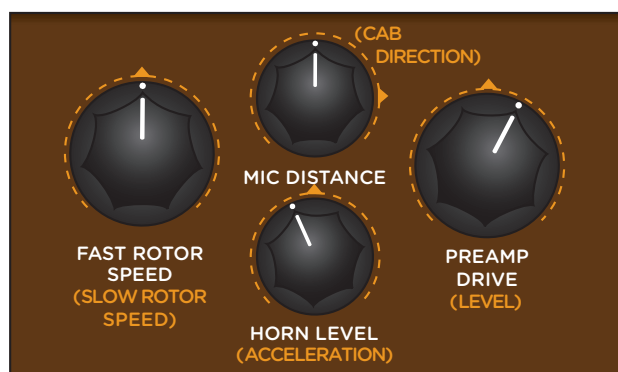

Classic Ballad

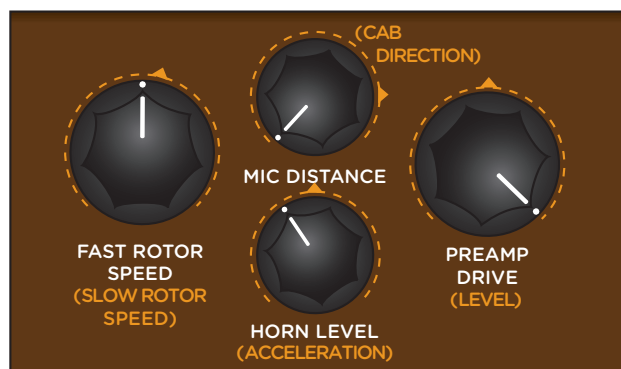

Maximum Drive

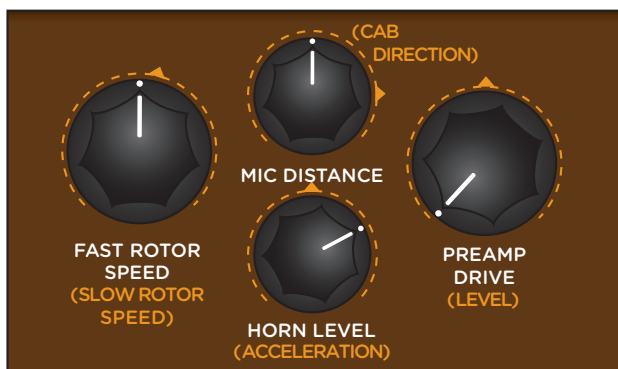

Swirly Horn

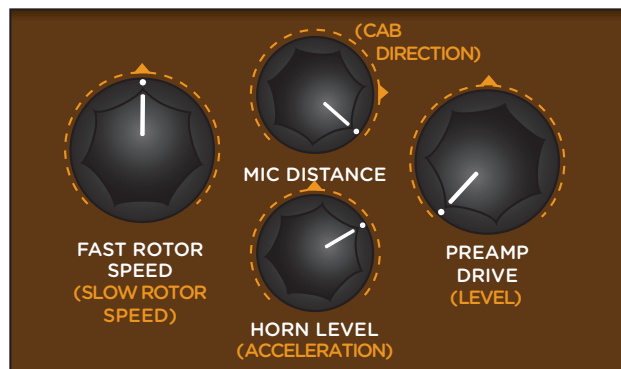

Distant Miking

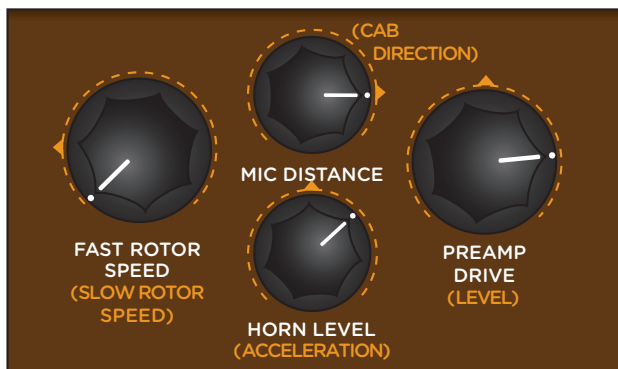

Slow Overdrive

Features

.....

- Hand crafted rotary algorithms for meticulous and nuanced recreations of rotary speaker systems
- Ultra Low Noise, high performance A/D and D/A Converters
- Premium analog front end and output section
- High Performance DSP
- Selectable cabinet orientation (front or rear facing)
- Fast and slow rotary speeds with independent horn and drum acceleration times
- Bi-amp output capability
- Stereo Output
- Expression pedal input with selectable control over any knob parameter
- Compatible with Favorite switch to save your favorite sound
- Remote switching of SLOW / FAST speeds with Favorite switch
- +/- 6dB level control
- SLOW / FAST footswitch with BRAKE feature
- Rugged & Lightweight Anodized Aluminum Chassis
- No-Nonsense User Interface
- True Bypass (electromechanical relay switching)

Specifications

.....

Input Impedance	1Meg Ohm
Output Impedance	100 Ohm
Signal to Noise	110 dB
A/D & D/A	24-bit 96kHz
Frequency Response	20Hz to 20kHz
Max Input Level	+8dBu
DSP performance	1596 MegaFLOPS
Bypass Switching	True Bypass (electromechanical relay switching)
Dimensions	4.5" deep x 4" wide x 1.75" tall

Power Supply

.....

Input Voltage	9VDC Center Negative
Required Current	250mA

Strymon Non-Transferrable Limited Warranty

Warranty

Strymon warrants the product to be free from defects in material and workmanship for a period of one (1) year from the original date of purchase. If the product fails within the warranty period, Strymon will repair or, at our discretion, replace the product at no cost to the original purchaser.

Exclusions

This warranty covers defects in manufacturing discovered while using this product as recommended by Strymon. This warranty does not cover loss or theft, nor does the coverage extend to damage caused by misuse, abuse, unauthorized modification, improper storage, lightning, or natural disasters.

Limits of Liability

In the case of malfunction, the purchaser's sole recourse shall be repair or replacement, as described in the preceding paragraphs. Strymon will not be held liable to any party for damages that result from the failure of this product. Damages excluded include, but are not limited to, the following: lost profits, lost savings, damage to other equipment, and incidental or consequential damages arising from the use, or inability to use this product. In no event will Strymon be liable for more than the amount of the purchase price, not to exceed the current retail price of the product. Strymon disclaims any other warranties, express or implied. By using the product, the user accepts all terms herein.

How to Obtain Service Under this Warranty

For North American customers: Contact Strymon through our website at <http://www.strymon.net/support> for Return Authorization and information. Proof of original ownership may be required in the form of a purchase receipt.

For International Customers: Contact the Strymon dealer from which the product was purchased from in order to arrange warranty repair service.

Strymon® is a division of Damage Control®, LLC.